



## About Warnings

 **WARNING:** A **WARNING** indicates a potential for property damage, personal injury, or death.

# Dell™ Vostro™ 1088 Setup and Features Information Tech Sheet

## Front View

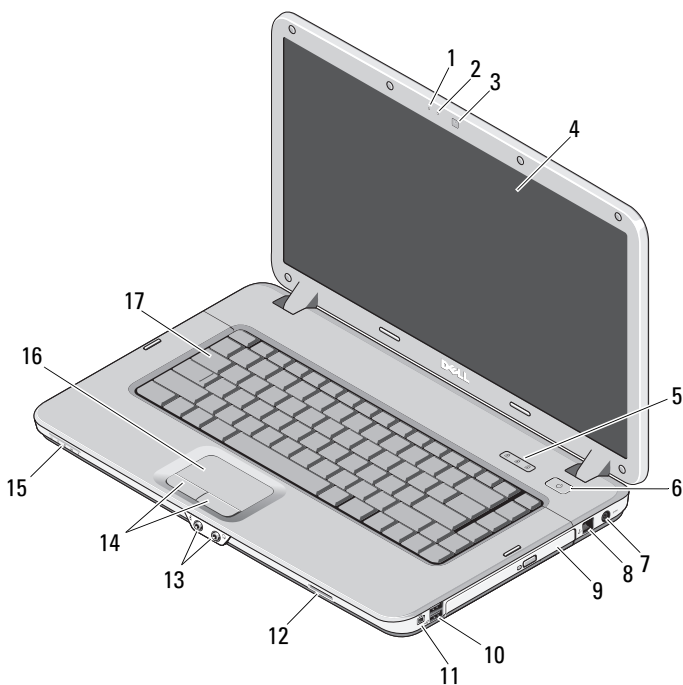

- 1 microphone (optional)
- 3 camera (optional)
- 5 keyboard status lights

- 2 camera light (optional)
- 4 display
- 6 power button

- 7 AC adapter connector
- 9 optical drive
- 11 IEEE 1394 connector
- 13 audio connectors (2)
- 15 indicator lens
- 17 keyboard

- 8 phone connector
- 10 USB connectors (2)
- 12 memory card reader
- 14 touchpad buttons (2)
- 16 touchpad

## Back View

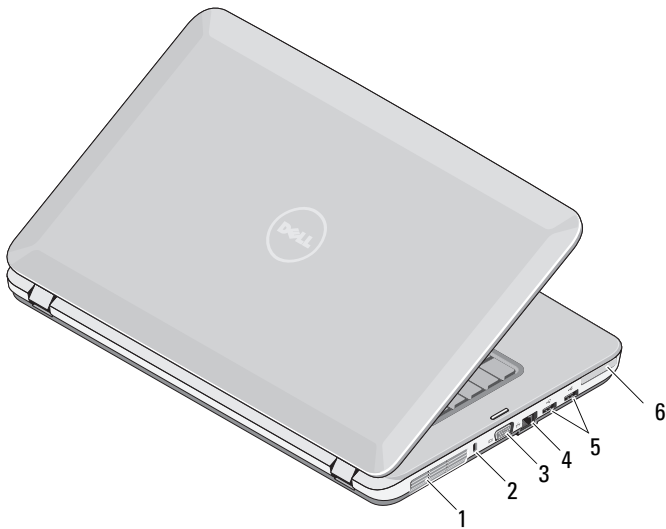

- 1 cooling vents
- 3 VGA connector
- 5 USB connectors (2)

- 2 security slot
- 4 network connector
- 6 34 mm ExpressCard slot

## Quick Setup



**WARNING:** Before you begin any of the procedures in this section, read the safety information that shipped with your computer. For additional best practices information, see [www.dell.com/regulatory\\_compliance](http://www.dell.com/regulatory_compliance).



**WARNING:** The AC adapter works with electrical outlets worldwide. However, power connectors and power strips vary among countries. Using an incompatible cable or improperly connecting the cable to the power strip or electrical outlet may cause fire or equipment damage.



**CAUTION:** When you disconnect the AC adapter cable from the computer, grasp the connector, not the cable itself, and pull firmly but gently to avoid damaging the cable. When you wrap the AC adapter cable, ensure that you follow the angle of the connector on the AC adapter to avoid damaging the cable.



**NOTE:** Some devices may not be included if you did not order them.

- 1 Connect the AC adapter to the AC adapter connector on the computer and to the electrical outlet.

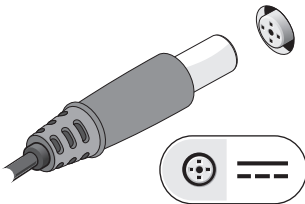

- 2 Connect the network cable (optional).

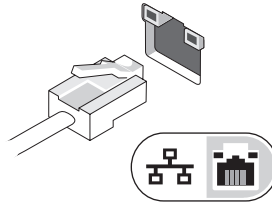

- 3 Connect USB devices, such as a mouse or keyboard (optional).

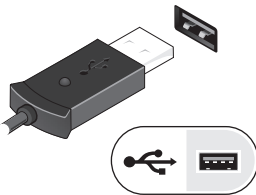

- 4 Connect IEEE 1394 devices, such as a DVD player (optional).

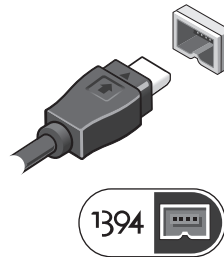

5 Open the computer display and press the power button to turn on the computer.



 **NOTE:** It is recommended that you turn on and shut down your computer at least once before you install any cards or connect the computer to a docking device or other external device, such as a printer.

## Specifications

 **NOTE:** Offerings may vary by region. The following specifications are only those required by law to ship with your computer. For more information regarding the configuration of your computer, click **Start**→ **Help and Support** and select the option to view information about your computer.

---

### System Information

---

Chipset	Intel® GM45
---------	-------------

---

### Processor

---

Processor	Intel Core™ 2 Duo or Intel™ Celeron (Socket P)
-----------	--

---

### Video

---

Video type	Discrete graphics
Data bus	PCI Express Graphic
Video controller	ATI Mobility Radeon™ HD 4330
Video memory	512 MB

---

**Memory**

---

Memory module connector	2 DIMM slots
Memory module capacity	1 GB or 2 GB
Memory type	DDR2 667 or 800 MHz
Minimum memory	1 GB
Maximum memory	4 GB

---

**Battery**

---

Type	smart lithium ion 6-cell
Dimensions	
Depth	53.39 mm (2.1 inches)
Height	20.44 mm (0.8 inch)
Width	206.44 mm (8.12 inches)
Voltage	11.1 V
Temperature range	
Operating	0° to 35°C (32° to 95°F)
Storage	-20° to 65°C (4° to 149° F)
Coin-cell battery	CR2032

---

**AC Adapter**

---

Type	90 W
Input voltage	100–240 VAC
Input current (maximum)	1.50 A
Input frequency	50–60 Hz
Output current	
90 W	5.62 A (maximum at 4 seconds pulse) 4.62 A (continuous)
Rated output voltage	19.50 VDC +/- 1.0 VDC
Temperature range	
Operating	0° to 35°C (32° to 95°F)
Storage	-40° to 65°C (-40° to 149°F)

---

**Physical**

---

Height	25–35.6 mm (0.98–1.4 inches)
Width	340 mm (13.38 inches)
Depth	242.5 mm (9.54 inches)
Weight	minimum 2.30 kg (5.066 lbs) with a 6-cell battery

---

**Environmental**

---

Temperature range	
Operating	0° to 35°C (32° to 95°F)
Storage	–40° to 65°C (–40° to 149°F)
Relative humidity (maximum)	
Operating	10% to 90% (noncondensing)
Storage	5% to 95% (noncondensing)

## Finding More Information and Resources

---

**If you need to:**

Find safety best practices information for your computer, review Warranty information, Terms and Conditions (U.S only), Safety instructions, Regulatory information, Ergonomics information, and End User License Agreement.

**See:**

The safety and regulatory documents that shipped with your computer and the Regulatory Compliance Homepage at [www.dell.com/regulatory\\_compliance](http://www.dell.com/regulatory_compliance).

---

**Information in this document is subject to change without notice.**

**© 2009 Dell Inc. All rights reserved.**

Reproduction of these materials in any manner whatsoever without the written permission of Dell Inc. is strictly forbidden.

Trademarks used in this text: *Dell*, the *DELL* logo, and *Vostro* are trademarks of Dell Inc.; *Intel* and *Celeron* are registered trademarks and *Core* is a trademark of Intel Corporation in the U.S. and other countries.

Other trademarks and trade names may be used in this document to refer to either the entities claiming the marks and names or their products. Dell Inc. disclaims any proprietary interest in trademarks and trade names other than its own.